

# ADB Technology Co., Ltd.

## High Current Multilayer Ferrite Chip Beads / CMF-HC Series

### Feature

Closed magnetic circuit structure allows high density mounting while preventing crosstalk.  
Extremely high reliability due to entirely due to entirely monolithic construction.  
Low DC resistance structure of electrode to prevent wasteful electric power consumption.  
High Current rating up to 6A.

### Application

Personal computers, communication equipment, digital telephone, electronic games machines, CRTs, hard disk drives, cellular phones, PDAs, printers High current DC lines and other computer peripheral products.

### Product Identification

**CMF 2012 RL 600 HC-3A**

1 2 3 4 5

1. Series name

4. Impedance

e. (600=60 Ω)

1

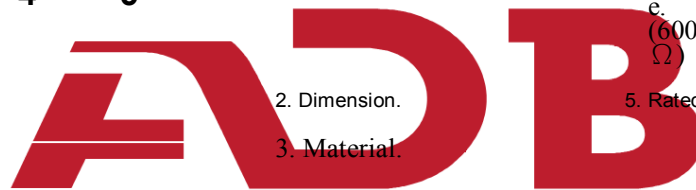

2. Dimension.

3. Material.

5. Rated current

### Configurations & Dimensions

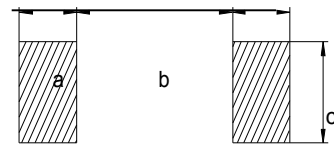
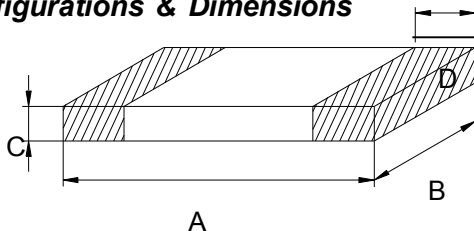

A

PCB Pattern

Series Name	A	B	C	D	a	b	c
CMF 1608-HC	1.6 ± 0.15	0.8 ± 0.15	0.8 ± 0.15	0.3 ± 0.2	1.0(REF)	0.6(REF)	0.8(REF)
CMF 2012-HC	2.0 ± 0.2	1.25 ± 0.2	0.85 ± 0.2	0.5 ± 0.3	1.0(REF)	1.0(REF)	1.0(REF)
CMF 3216-HC	3.2 ± 0.2	1.6 ± 0.2	1.1 ± 0.2	0.5 ± 0.3	1.1(REF)	2.2(REF)	1.6(REF)
CMF 3225-HC	3.2 ± 0.2	2.5 ± 0.2	1.3 ± 0.2	0.5 ± 0.3	1.1(REF)	2.2(REF)	3.4(REF)
CMF 4516-HC	4.5 ± 0.2	1.6 ± 0.2	1.6 ± 0.2	0.5 ± 0.3	1.5(REF)	2.7(REF)	1.6(REF)
CMF 4532-HC	4.5 ± 0.2	3.2 ± 0.2	1.5 ± 0.2	0.5 ± 0.3	1.67(REF)	2.57(REF)	4.22(REF)
CMF 5750-HC	5.7 ± 0.2	5.0 ± 0.3	1.8 ± 0.2	0.5 ± 0.3			

Unit: mm

# ADB Technology Co., Ltd.

## High Current Multilayer Ferrite Chip Beads / CMF-HC Series

### Electrical Characteristics

<i>CMF1608-HC Series</i>				
Part Number	Impedance ( $\Omega$ ) $\pm$ 25%	Test Frequency ( MHz )	DC Resistance Max. ( $m\Omega$ )	Rated Current Max. ( mA )
CMF 1608RL300HC-3A	30	100	40	3,000
CMF 1608RL600HC-3A	60	100	40	3,000
CMF 1608RL800HC-3A	80	100	40	3,000
CMF 1608RL101HC-3A	100	100	30	3,000
CMF 1608RL121HC-2A	120	100	100	2,000
CMF 1608RL121HC-3AU	120	100	25	3,000
CMF 1608RL151HC-2A	150	100	100	2,000
CMF 1608RL181HC-2A	180	100	100	2,000
CMF 1608RL221HC-2A	220	100	100	2,000
CMF 1608RL221HC-2A5	220	100	60	2,500
CMF 1608RL601HC-2A	600	100	150	2,000
CMF 1608RL301HC-1A	300	100	200	1,000
CMF 1608RL471HC-1A	470	100	200	1,000
CMF 1608RL601HC-1A	600	100	200	1,000
CMF 1608RL102HC-A8	1K	100	300	800
<i>CMF2012-HC Series</i>				
Part Number	Impedance ( $\Omega$ ) $\pm$ 25%	Test Frequency ( MHz )	DC Resistance Max. ( $m\Omega$ )	Rated Current Max. ( mA )
CMF 2012RL300HC-4A	30	100	14	4,000
CMF 2012RL300HC-3A	30	100	40	3,000
CMF 2012RL600HC-3A	60	100	40	3,000
CMF 2012RL800HC-3A	80	100	40	3,000
CMF 2012RL121HC-3A	120	100	40	3,000
CMF 2012RL151HC-2A	150	100	100	2,000
CMF 2012RL221HC-2A	220	100	100	2,000
CMF 2012RL601HC-2A	600	100	100	2,000
CMF 2012RL301HC-2A	300	100	80	2,000
CMF 2012RL331HC-1A5	330	100	80	1,500
CMF 2012RL471HC-1A	470	100	200	1,000
CMF 2012RL601HC-1A	600	100	200	1,000
CMF 2012RL102HC-1A5	1000	100	150	1,500
CMF 2012RL152HC-1A	1500	100	300	1,000

# ADB Technology Co., Ltd.

## High Current Multilayer Ferrite Chip Beads / CMF-HC Series

<b>CMF3216-HC Series</b>				
<b>Part Number</b>	<b>Impedance (<math>\Omega</math>) <math>\pm</math> 25%</b>	<b>Test Frequency ( MHz )</b>	<b>DC Resistance Max. ( <math>m\Omega</math> )</b>	<b>Rated Current Max. ( mA )</b>
CMF3216RL300HC-3A	30	100	40	3,000
CMF 3216RL500HC-3A	50	100	40	3,000
CMF 3216RL800HC-3A	80	100	40	3,000
CMF 3216RL900HC-2A	90	100	40	2,000
CMF 3216RL900HC-3A	90	100	40	3,000
CMF 3216RL101HC-3A	100	100	40	3,000
CMF 3216RL121HC-2A	120	100	100	2,000
CMF 3216RL121HC-6AU	120	100	12	6,000
CMF 3216RL151HC-2A	150	100	100	2,000
CMF 3216RL301HC-1A	300	100	200	1,000
CMF 3216RL471HC-1A	470	100	200	1,000
CMF 3216RL501HC-3A	500	100	40	3,000
CMF 3216RL601HC-2A	600	100	100	2,000
CMF 3216RL102HC-1A2	1000	100	300	1,200

The logo for ADB Technology Co., Ltd. features the letters 'A', 'D', and 'B' in a bold, red, sans-serif font. The 'A' and 'D' are connected at their top and bottom curves, and the 'B' is positioned to the right of the 'D'.

# ADB Technology Co., Ltd.

## High Current Multilayer Ferrite Chip Beads / CMF-HC Series

### Electrical Characteristics

<b>CMF3225-HC Series</b>				
<b>Part Number</b>	<b>Impedance (<math>\Omega</math>) <math>\pm</math> 25%</b>	<b>Test Frequency ( MHz )</b>	<b>DC Resistance Max. ( <math>m\Omega</math> )</b>	<b>Rated Current Max. ( mA )</b>
CMF 3225RL600HC-4A	60	100	30	4,000
CMF 3225RL900HC-2A	90	100	100	2,000
CMF 3225RL151HC-5A	150	100	20	5,000
CMF 3225RL201HC-4A	200	100	30	4,000
CMF 3225RL601HC-2A	600	100	200	2,000
<b>CMF4516-HC Series</b>				
<b>Part Number</b>	<b>Impedance (<math>\Omega</math>) <math>\pm</math> 25%</b>	<b>Test Frequency ( MHz )</b>	<b>DC Resistance Max. ( <math>m\Omega</math> )</b>	<b>Rated Current Max. ( mA )</b>
CMF 4516RL600HC-6A	60	100	10	6,000
CMF 4516RL800HC-3A	80	100	40	3,000
CMF 4516RL102HC-1.5A	1000	100	150	1,500
<b>CMF4532-HC Series</b>				
<b>Part Number</b>	<b>Impedance (<math>\Omega</math>) <math>\pm</math> 25%</b>	<b>Test Frequency ( MHz )</b>	<b>DC Resistance Max. ( <math>m\Omega</math> )</b>	<b>Rated Current Max. ( mA )</b>
CMF 4532RL800HC-6A	80	100	10	6,000
CMF 4532RL121HC-6A	120	100	30	6,000
CMF 4532RL131HC-3A	130	100	40	3,000
CMF 4532RL151HC-5A	150	100	20	5,000
CMF 4532HL681HC-4A	680	100	30	4,000
CMF 4532HL132HC-3A	1300	100	60	3,000